

Assembly Instructions for Model 155 Hand Stand Drum Truck

Modified design as of 05/2004 requires some assembly and saves on shipping charges.

1. Slide the Handle Assembly tube through the Hook Slide Weldment (item 25) and into the Base Assembly tube and align drilled holes.
2. Insert bolt (item 21) through the aligned holes and secure with Lock Nut (item 22) to fasten the Handle Assembly to the Base Assembly.

Note: Hook Slide Weldment slides freely on the Handle assembly tube to engage the upper rim of your drum.

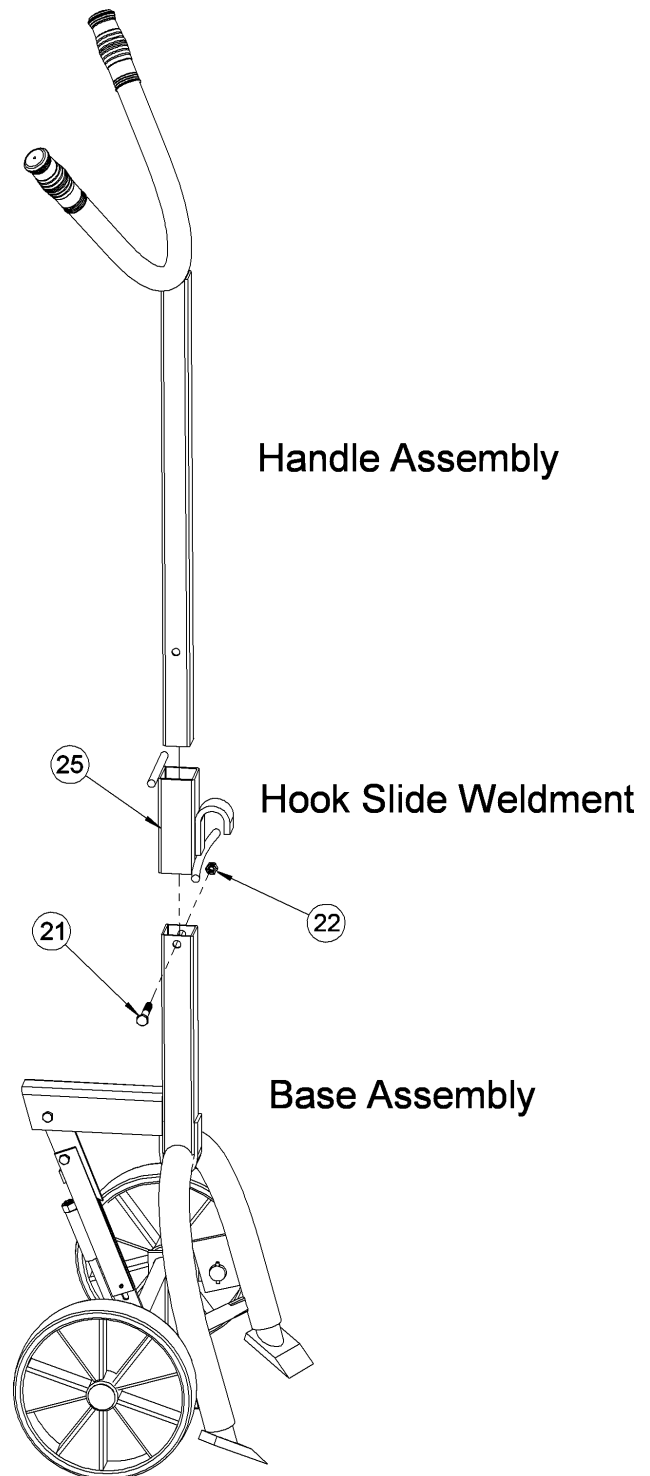

Parts List and Diagram for Model 155 Hand Stand Drum Truck

ITEM	QTY.	PART #	DESCRIPTION
1	1	3972-P	BASE WELD, 155
2	1	1969-P	AXLE WELD, 155
3	2	1971-P	PEG WELD, 155
7	1	1962-P	BEVEL LINK, 155
8	1	1970-P	STAND WELD, 155
9	2	1968-P	TUBING, 5/8 OD X .688, 90, 155
10	1	35-P	5/16 - 18 X 1 HHCS GR 2
11	2	491-P	5/16 - 18 REV HEX LOC NUT
12	2	64-P	ROLL PIN, 3/16 X 1-1/4
13	1	176-P	ROLL PIN, 3/16 X 3/4
14	1	3970-P	HANDLE WELD, 152, 153, 155
15 *	2	702-P	WHEEL, RUBBER, 10", 7/8" BORE
16	2	1953-P	WHEEL SPACER, 152, 153, 155
17 *	2	706-P	PUSH-ON HUB CAP, 7/8"
18	1	1954-P	5/16 - 18 X 2 1/2 HHCS GR 2
19	1	1110-P	SPRING, COMPRESSION, 155
20	1	1007-P	SET SCREW, 1/2 - 13 X 3/4 CUP
21	1	82-P	3/8 - 16 X 2-1/4 HHCS GR 2
22	1	1169-P	3/8 - 16 REV HEX LOC NUT
23	2	83-P	HANDLE GRIP, 1-1/4 X 4-1/2
25	1	1947-P	HOOK SLIDE WELD, 152

* Recommended spare parts

