

**PARTS LIST AND DIAGRAM for**  
**MORSE MODEL 40 Drum Cradle Truck**  
**MODEL 40-A Drum Cradle Truck, Aluminum**  
 Serial # \_\_\_\_\_ - \_\_\_\_\_

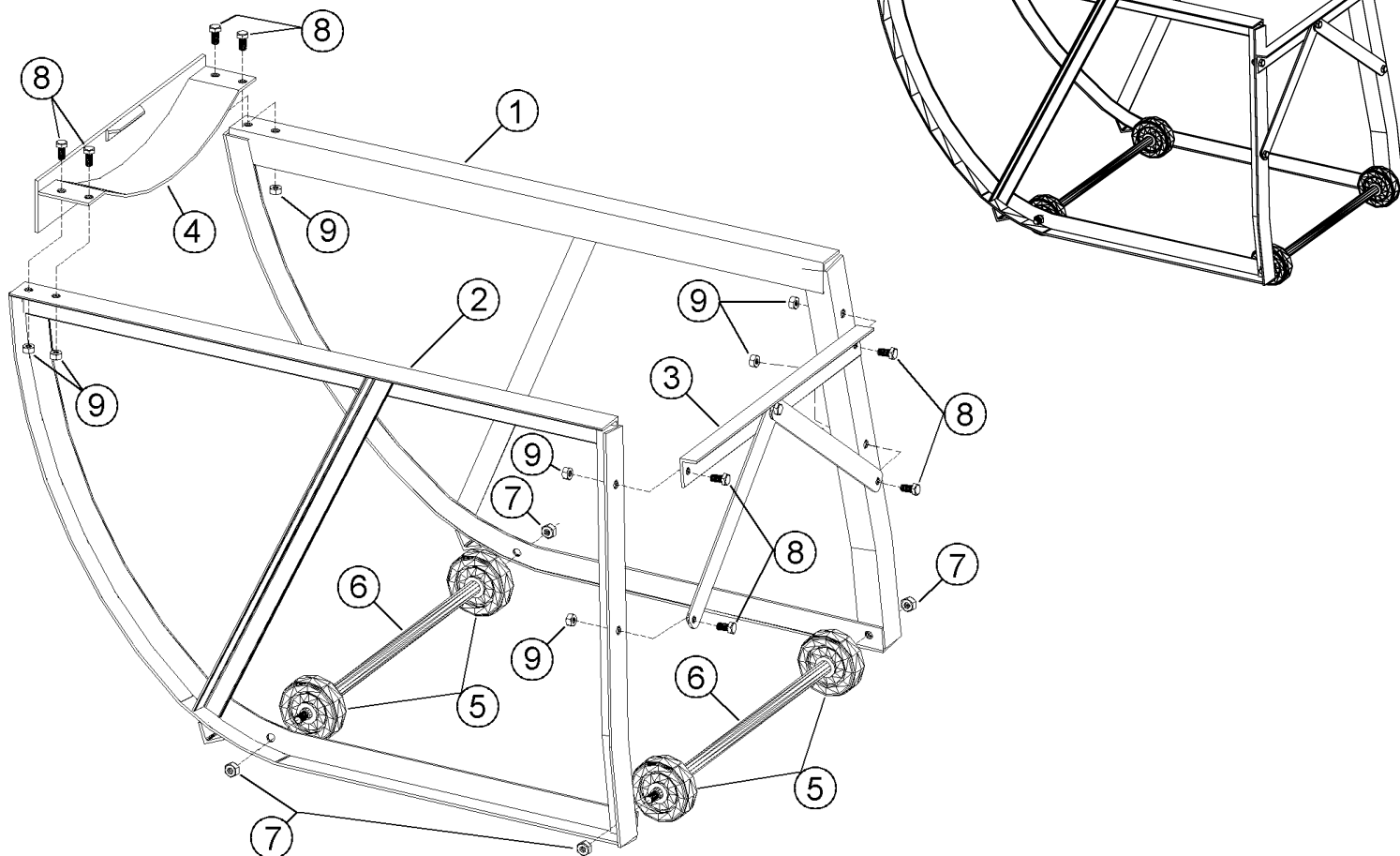

MODEL 40 PARTS LIST			
ITEM	QTY	P/N	DESCRIPTION
1	1	1910L-P	SIDE FRAME WELD, LEFT
2	1	1910R-P	SIDE FRAME WELD, RIGHT
3	1	1915-P	ASM, BACK STRAP, 40
4	1	1918-P	WELD, NOSE PIECE, 40
5	4	210-P	WHEEL, MORTUF 3" X 1/2"BORE 36
6	2	209-P	AXLE, 5/8" X 18", 40
7	4	1169-P	3/8 - 16 REV HEX LOC NUT
8	8	215-P	5/16 - 18 X 5/8 HHCS GR 2
9	8	172-P	5/16 - 18 FIN HEX NUT

MODEL 40-A PARTS LIST			
ITEM	QTY	P/N	DESCRIPTION
1	1	1924L-P	SIDE FRAME WELD LEFT 40-A
2	1	1924R-P	SIDE FRAME WELD RIGH 40-A
3	1	1918A-P	WELD, NOSE PIECE, 40 A
4	1	1915A-P	ALUM BACK STRAP, ASM, 40-A
5	4	210-P	WHEEL, MORTUF 3" X 1/2"BORE 36
6	2	1937-P	AXLE, 5/8" X 18", 40-A
7	8	1878-P	5/16 - 18 X 3/4 HHCS ALUM
8	8	1934-P	5/16 - 18 HEX NUT ALUM
9	4	1880-P	3/8 - 16 HEX NUT ALUM

### ASSEMBLY INSTRUCTIONS FOR MORSE MODELS 40 AND 40-A

#### 1. Attach Axles and Wheels

Remove paint from ends of each axle. Apply a small amount of bearing grease to wheel bearing surface on each axle. Slide one wheel (item 5) onto each end of both axles (item 6). With the angle iron on each side frame (item 1 & 2) facing away from each other (see diagram at right), insert threaded ends of axles into holes in side frames and hand tighten a 3/8 nut (item 7) onto each axle end.

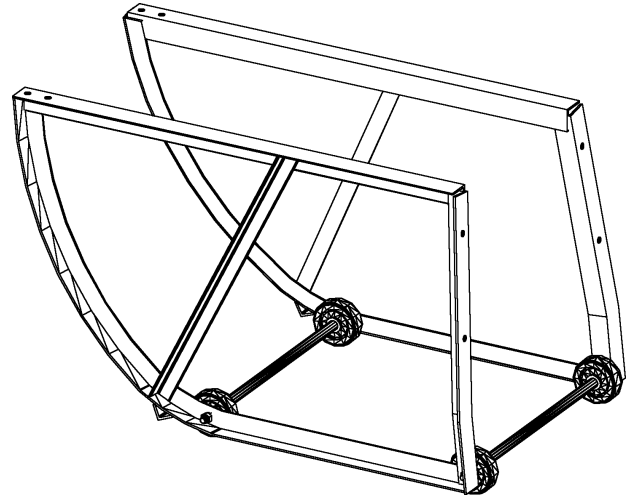

**DO NOT TIGHTEN BOLTS UNTIL TRUCK IS ENTIRELY ASSEMBLED.**

#### 2. Attach Nose Piece

Fasten nose piece (item 4) to top of side frames using four 5/16 x 5/8" bolts (item 8). Hand tighten 5/16 nut (item 9) on each bolt.

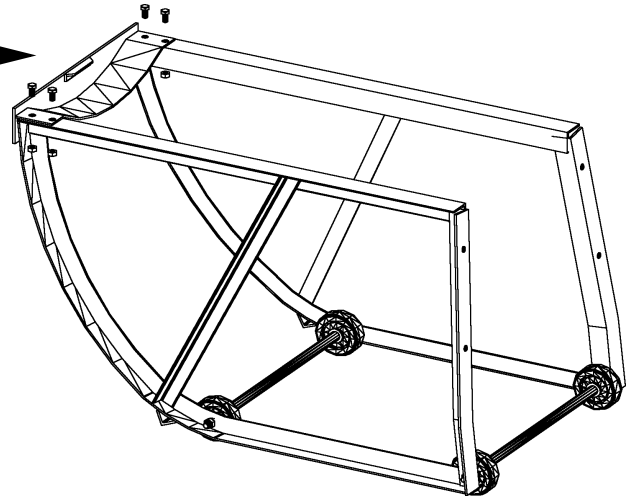
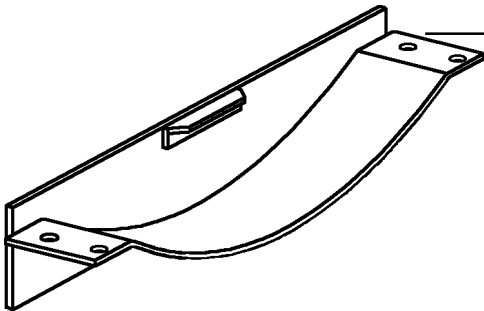

#### 3. Attach Back Strap

Fasten back strap (item 3) to back of side frames using four 5/16 x 5/8" bolts (item 8) and 5/16 nuts (item 9). Hand Tighten each bolt.

#### 4. Tighten all bolts & nuts

Tighten bolts and nuts, alternating left and right to maintain straight frame.

- For replacement parts, please contact your Morse dealer.
- When ordering parts, please specify:
  - Part number and description
  - Model and Serial numbers

