

Parts List and Diagram for Morse Option # POLY-2-5154
to roll 55-gallon plastic drums on 2-5154 Series Drum Roller

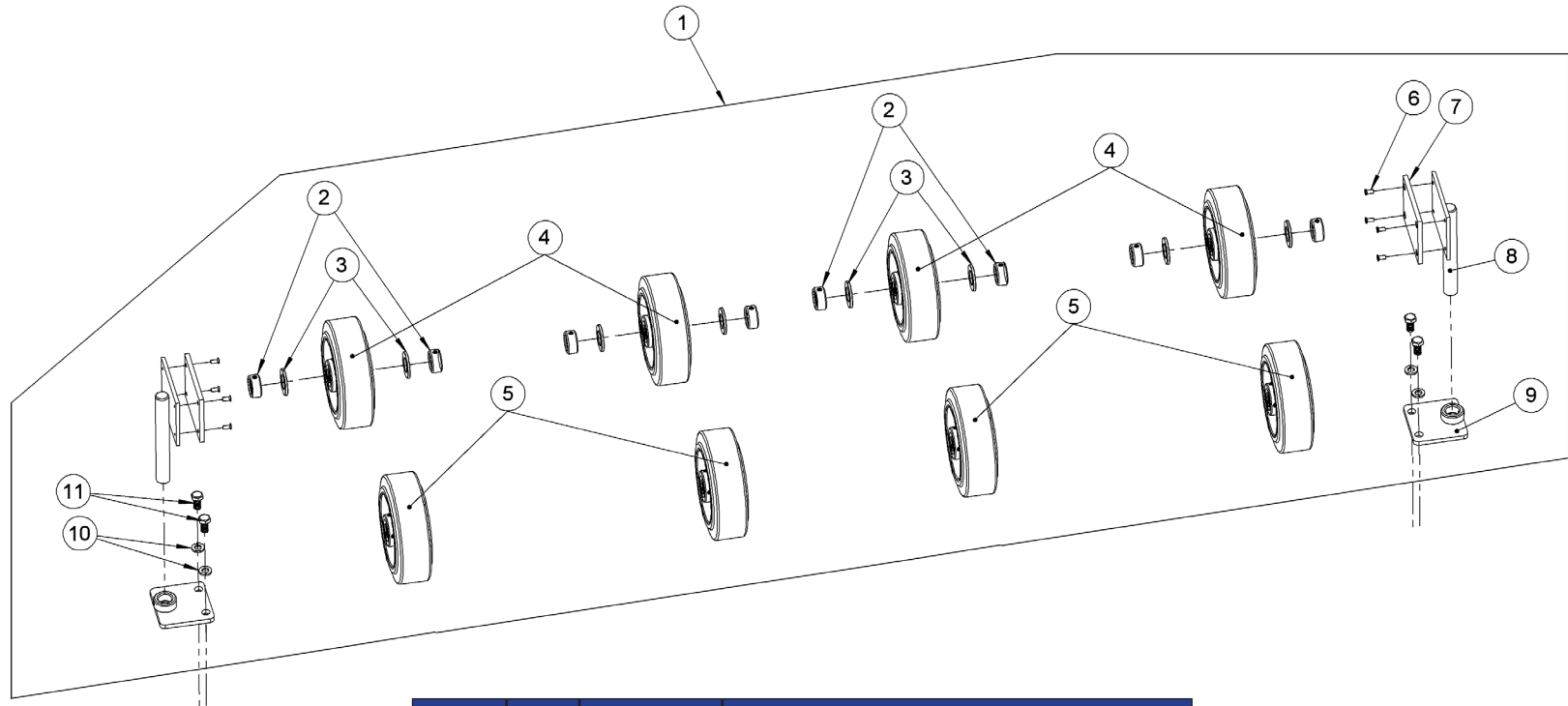

| ITEM # | QTY. | PART # | DESCRIPTION |
|--------|------|-------------|------------------------------|
| 1 | 1 | POLY-2-5154 | OPTION, POLY DRUMS 2-5154 |
| 2 | 8 | 15-P | COLLAR, 3/4" ID |
| 3 | 8 | 55-P | WASHER, 3/4 SAE FL 1-1/2 OD |
| 4 | 4 | 292-P | WHEEL, IDLER, 6" W/ 3/4" BRG |
| 5 | 4 | 291-P | WHEEL, DRIVE, 6", 1" BORE |
| 6 | 8 | 248-P | FHMS, 10-24 X 3/8 |
| 7 | 2 | 327-P | WEAR PAD, UHMW, TIVAR, 201B |
| 8 | 2 | 4053-P | END STOP WELD, 456 5154 |
| 9 | 2 | 4056-P | BASE PLATE WELD 456 POLY |
| 10 | 4 | 1474-P | WASHER, 3/8 SPLIT LOCK |
| 11 | 4 | 1657-P | HHCS, 3/8-16 X 3/4 GR2 |